



Crisp Road, W6

£1,405,000 Leasehold

1108 sq ft (103 m²) • 3 bedrooms • 3 bathrooms (2 en suite)
living/dining room • kitchen • 2 dressing rooms • 2 balconies
underground parking • river views



**Approximate gross floor area:
1108 sq ft (103 m²)
Includes Cellar or Storage Space
where applicable**

FOR ILLUSTRATIVE PURPOSES
ONLY. NOT TO SCALE.

As defined by RICS code of
measuring practice

This floorplan is representative and for illustrative purposes only. The measurements provided are approximate only and not to scale. They should not be relied upon by any party. Prospective purchasers or tenants are advised to carry out their own survey if they require reliable measurements. No responsibility is taken for any error, omission, misstatement or use of data shown.
Details Prepared: 4 August 2017

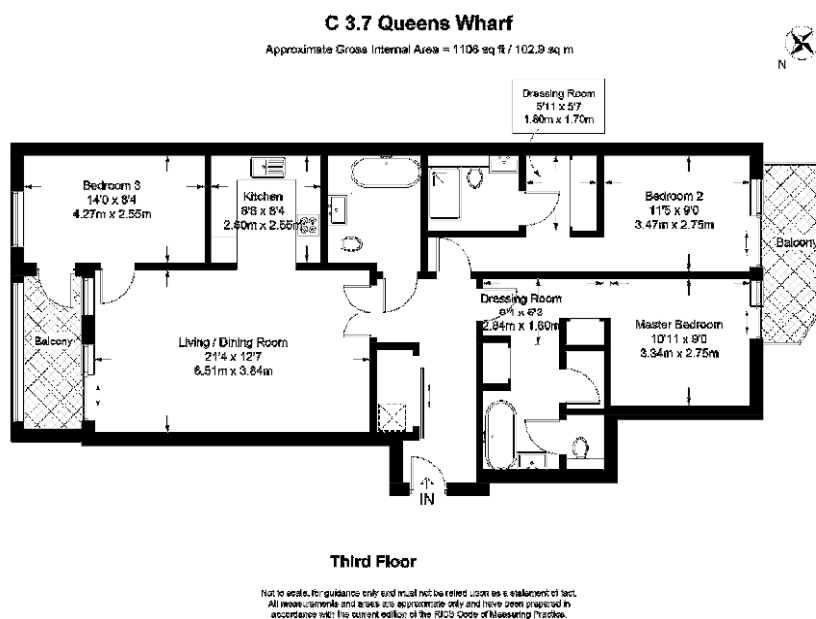

This three bedroom, three bathroom apartment has been crafted with imagination and consideration to deliver an efficient use of space, and to give a light and airy feel. The attention to detail leaves a high quality appearance, with finishes including engineered timber flooring, chrome ironmongery and stone worktops.

Queen's Wharf offers the rare opportunity to live along a stretch of the world -famous and beautifully unspoilt, River Thames. Queen's Wharf is a stunning new development located on the 'Surrey Bend' of the River Thames, in close proximity to the Grade II listed Hammersmith Bridge. The building has been carefully designed to maximise the panoramic views.

The developments proximity to both Fulham and Chelsea give the residence an undertone of sophisticated creativity.

The complex boasts a central landscape podium garden for residence to enjoy in private. Further amenities include 24-hour concierge, a rooftop terrace, a restaurant, café, bar and an independent theatre and cinema, managed by world-famous Riverside Studios.

Good to know

Local authority: Hammersmith & Fulham

Council tax band: Unknown

Hammersmith & Shepherds Bush Office

118-120 Glenthorne Road, W6 0LP

hammsales@dng.co.uk

020 8563 7100

douglasandgordon.com

